

Technical details

Metric

Inch

Operating conditions

Maximum Speed	1.0 m/sec
Temperature Range	-45°C +110°C
Maximum Pressure	400 bar*

3.0 ft/sec
-50°F +230°F
6000 p.s.i.

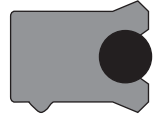

Maximum extrusion gap

Figures show the maximum permissible gap all on one side using minimum rod \varnothing and maximum clearance \varnothing .

Surface roughness

	μmRa	μmRt	μinCLA	μinRMS
Dynamic Sealing Face $\varnothing D_1$	0.1 <-> 0.4	4 max	4 <-> 16	5 <-> 18
Static Sealing Face $\varnothing d_1$	1.6 max	10 max	63 max	70 max
Static Housing Faces L_1	3.2 max	16 max	125 max	140 max

Chamfers & Radii

	4.0	5.0	7.5	10.0	12.5	15.0
Groove Section $\leq S$ in						
Min Chamfer C in	3.0	3.5	5.0	6.5	7.0	8.0
Max Fillet Rad r_1 in	0.2	0.4	0.8	0.8	1.2	1.6
Max Fillet Rad r_2 in	0.125	0.187	0.250	0.312	0.375	0.500

Tolerances

$\varnothing d_1$	$\varnothing D_1$	L_1 in
f9	Js11	+0.010 -0

620

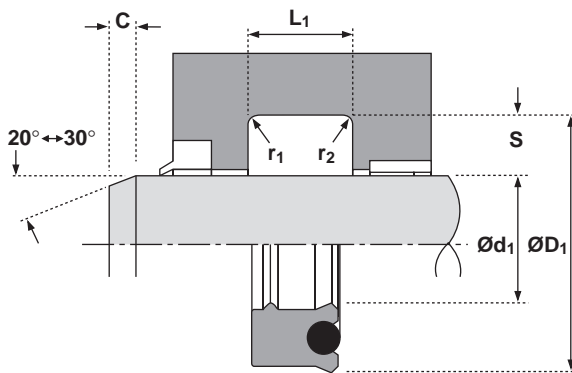

Design

Hallite's 620 design incorporates features from the Hallite 621 to provide a twin lip alternative to Hallite's 500 series products.

The shell is moulded in Hallite's high performance polyurethane - Hythane® 181 - ensuring flexibility for easy installation and performance at low temperatures. The 620 benefits from the Hallite's twin lip profile for dry rod sealing.

Features

- **Twin lip design offering:**
 - Lower friction
 - Improved sealing
 - Primary lip protection
 - Increased seal stability
- Improved shock handling
- Easy installation
- Complete lip actuation

620

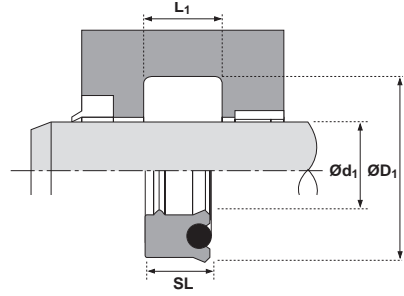

$\varnothing d_1$	TOL f9	$\varnothing D_1$	TOL Js11	SL	L_1 +0.010 -0	PART No.
0.625	-0.0006 -0.0023	0.875	+0.003 -0.003	0.160	0.176	4498600
0.625	-0.0006 -0.0023	0.875	+0.003 -0.003	0.175	0.190	4528700
0.625	-0.0006 -0.0023	0.875	+0.003 -0.003	0.250	0.275	4459900
0.750	-0.0008 -0.0028	1.000	+0.003 -0.003	0.187	0.207	4583900
0.750	-0.0008 -0.0028	1.000	+0.003 -0.003	0.250	0.275	4498500
0.875	-0.0008 -0.0028	1.125	+0.003 -0.003	0.187	0.207	4709100
1.000	-0.0008 -0.0028	1.240	+0.003 -0.003	0.187	0.217	4477200
1.000	-0.0008 -0.0028	1.250	+0.003 -0.003	0.187	0.207	4457500
1.000	-0.0008 -0.0028	1.250	+0.003 -0.003	0.250	0.275	4498400
1.000	-0.0008 -0.0028	1.375	+0.003 -0.003	0.250	0.275	4410400

$\varnothing d_1$	TOL f9	$\varnothing D_1$	TOL Js11	SL	L_1 +0.010 -0	PART No.
1.000	-0.0008 -0.0028	1.375	+0.003 -0.003	0.312	0.344	4584000
1.125	-0.0010 -0.0034	1.375	+0.003 -0.003	0.250	0.275	4461100
1.125	-0.0010 -0.0034	1.500	+0.003 -0.003	0.250	0.275	4410500
1.250	-0.0010 -0.0034	1.500	+0.003 -0.003	0.187	0.207	4398900
1.250	-0.0010 -0.0034	1.500	+0.003 -0.003	0.250	0.275	4461000
1.250	-0.0010 -0.0034	1.625	+0.003 -0.003	0.312	0.344	4410600
1.375	-0.0010 -0.0034	1.750	+0.003 -0.003	0.312	0.344	4410700
1.500	-0.0010 -0.0034	1.875	+0.003 -0.003	0.375	0.413	4750600
1.750	-0.0010 -0.0034	2.125	+0.004 -0.004	0.375	0.413	4460000